

50x50 STAINLESS STEEL 316L EARTH BOSS TYPE A

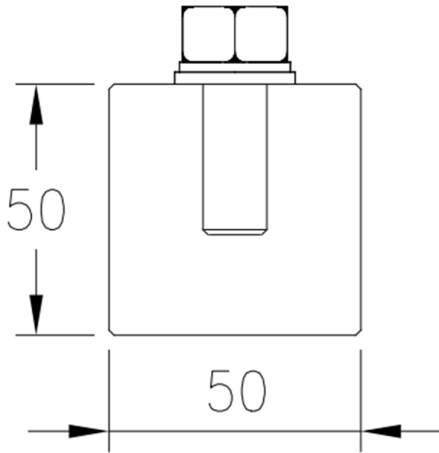

PART NUMBER: BOSS-050050012

CHARACTERISTICS

The Earth Boss made from stainless steel 316L is specifically designed to provide a reliable and long-lasting grounding connection. It consists of a termination bolt and a chamfer bottom surface that can be welded securely to a structure or equipment. This bottom surface can be a drilled hole with threaded connection to accommodate installation upon request.

PRODUCT PROPERTIES

Complies With: IEC 62561-1:2017 Class H

Material: Stainless steel 316L

Length: 50 mm

Diameter: 50 mm

Termination Bolt: M12 x 40mm